



LAKE SIDE HOTEL & SPA

LAKE WINDERMERE



The Ultimate Conference Resort

Lakeside, set in the heart of the Lake District, provides the perfect venue for meetings, conferences, and training and development days. You can create strategies, develop team building, reward and recognise staff, in our unrivalled environment that encourages fresh thinking, open minds and new ways of working.

The beauty of our hotel is that we are also easily accessible from all parts of the UK, which makes us a truly national conference centre. Just 15 minutes from the M6, ninety minutes away from Manchester Airport, Manchester and Leeds, while being equidistant from Glasgow, Edinburgh and Birmingham. We are now under 3 hours direct from London, but once here you'll feel a million miles away from them all!



Windermere Suite at Lakeside

An exclusive business venue with its own luxury 4-star hotel. The beauty of our new venue is that your company has it all to yourselves, offering you and your delegates the best of all possible worlds - the discreet privacy afforded by our Windermere Suite and the four-star splendour of the Lakeside Hotel.

www.Lakesidehotel.co.uk/windermeresuite



Conference Tariffs

All our inclusive rates are per person per day. Our bedrooms enjoy individually designed fabrics and colours, superb furnishings and the facilities you would expect. To enhance your stay, our luxury Health and Leisure Spa is exclusively available to hotel residents.

24 hour delegate rate

(Sunday to Friday inclusive)

Inclusive of morning coffee, danish, fresh fruit and freshly squeezed orange juice on arrival, 3 course buffet lunch, afternoon tea and home made scones, 4 course dinner, overnight accommodation in a double room, full English breakfast, meeting room and standard equipment hire.

Single occupancy of twin/double - from £140 - £220 +VAT

Twin occupancy - from £130 - £190 +VAT per person

48 hour weekend delegate rate

(to include a Saturday night)

Single occupancy of twin/double - from £330 - £480 +VAT

Twin occupancy - from £270 - £310 +VAT per person

Day delegate rate

Inclusive of meeting room and standard equipment hire, morning coffee, danish, fresh fruit and freshly squeezed orange juice on arrival, 3 course buffet lunch, afternoon tea and home made scones - from £45 - £65 +VAT.

Exclusive Use

Lakeside Hotel can be booked for exclusive use. This means exclusivity and your conference will have the flexibility to make full use of our restaurants, bars and public areas. Prices are available upon application.

Syndicate room hire for residential conference

Syndicate from £125 per day.

Christmas celebration conference

Please enquire for details or see our website www.Lakesidehotel.co.uk

Fresh ideas..?

Looking for something different for your next business conference? Here's something that will really inspire, motivate and reward...providing you with a refreshing break from the conventional conference.

We've created a special collection of fresh ideas for conferences, all centred on Lakeside, the **Ultimate Conference Resort** with everything on site for successful away days, superb hotel, luxurious pool and spa, and stunning Lake District scenery.

We've all been there, sat in a drab, dull and uninspiring conference environment counting the hours until it's all over. Not at Lakeside, based in the beautiful Lake District, not only will your conference be set in outstanding surroundings but also, once it is over, you will never be short of something to see or do.

There's every kind of activity to suit your delegates and your objectives. Everything is located on-site at Lakeside, so there are no additional transport costs or time spent on travel. It's 100% business and pleasure.

All prices subject to change without notice.

www.LakeDistrictConferences.co.uk

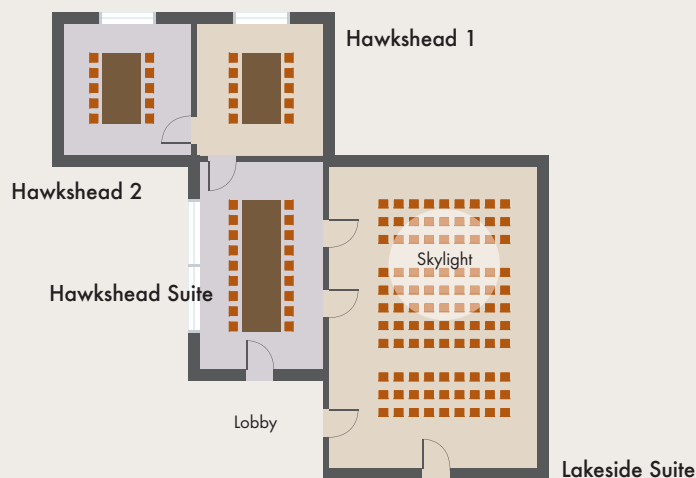
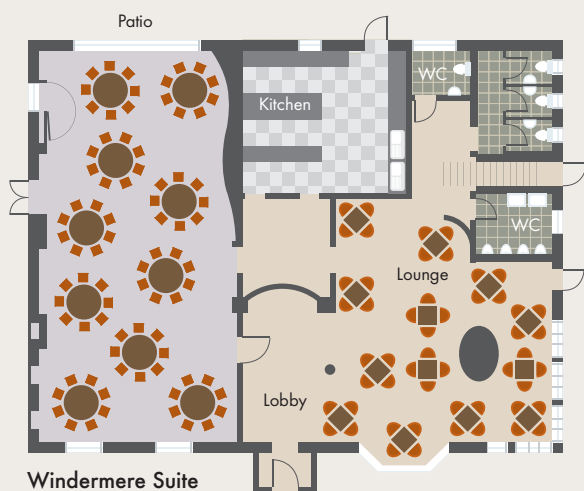

Conference Specifications

| Suites | Maximum Capacities | | | | | | Max Dimensions | | |
|--------------------|--------------------|-----------|-----------|---------|---------|----------|----------------|-------|------|
| | Theatre | Classroom | Boardroom | Cabaret | Banquet | U-Shaped | H | L | W |
| Windermere | 100 | 70 | 40 | 70 | 80 | 36 | 4.00 | 15.50 | 7.50 |
| Lakeside | 100 | 80 | 40 | 70 | 80 | 32 | 3.50 | 11.50 | 8.00 |
| Rusland | 34 | 24 | 26 | 24 | ~ | 22 | 2.25 | 9.00 | 5.25 |
| Tarn Hows | 30 | 20 | 22 | 20 | 20 | 18 | 2.40 | 6.50 | 6.00 |
| Hawkshead | 30 | 20 | 22 | 20 | 20 | 18 | 3.00 | 8.00 | 5.00 |
| Grizedale | 30 | 20 | 22 | 20 | ~ | 18 | 2.50 | 7.00 | 5.50 |
| Levens/Rydal | 25 | 15 | 16 | 15 | ~ | 12 | 2.50 | 6.00 | 5.00 |
| Esthwaite/Grasmere | 25 | 15 | 16 | 15 | ~ | 12 | 2.50 | 6.00 | 5.00 |
| Hawkshead 1 | 20 | 15 | 12 | 10 | ~ | 10 | 2.50 | 5.50 | 5.00 |
| Hawkshead 2 | 20 | 15 | 12 | 10 | ~ | 10 | 2.50 | 5.50 | 5.00 |